

**Program for
the 2018 Annual
Central States Regional Meeting**

The Society of Biblical Literature

***Plenary Speaker
Dr. Barbara Rossing***

**Professor of New Testament
Lutheran School of Theology at Chicago**

March 11-12, 2018

**Stoney Creek Hotel & Conference Center
Columbia, Missouri
2601 S. Providence Road
Columbia, Missouri 65203**

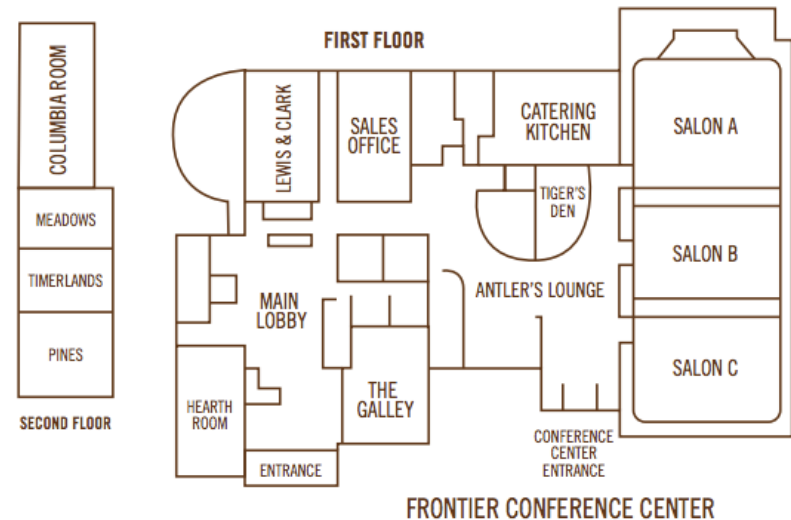

Room Assignments:

Book Display -----Columbia Room
Plenary Sessions -----Salon C
Pedagogy ----- Timberlands
Gender Studies----- Timberlands
Hebrew Bible -----Timberlands
New Testament -----Columbia Room

**Rooms subject to change; updated schedule
will be available at the meeting registration table**

Keynote Speaker for the 2018 Meeting:

Dr. Barbara R. Rossing

Professor of New Testament
Lutheran School of Theology at Chicago

Title: "Ecology and the Book of Revelation"

BARBARA R. ROSSING is Professor of New Testament at the Lutheran School of Theology at Chicago, where she also directs environmental initiatives. She currently chairs the Ecological Hermeneutics Section of the Society of Biblical Literature, and has served on the steering committees of the SBL "Bible and Popular Culture" and "John's Apocalypse and Cultures Ancient and Modern" sections. An avid environmentalist, Rossing received the bachelor of arts degree in Geology from Carleton College, the master of divinity degree from Yale University Divinity School and the doctor of theology degree from Harvard University. She is the author of *The Rapture Exposed: The Message of Hope in the Book of Revelation*, *The Choice Between Two Cities: Whore, Bride and Empire in the Apocalypse*, and articles and book chapters on Revelation and ecology, including "Revelation" in the *Fortress Commentary on the New Testament*. Her interdisciplinary work on apocalyptic eschatologies and intersections with religion and science has been supported by fellowships from the Association of Theological Schools, the Henry Luce Foundation, the John Templeton Foundation, and The Enhancing Life Project of the University of Chicago.

Message from the Regional Coordinator

Dear Colleagues,

Let me thank the various section leaders, who are responsible for putting together our sessions: Mark Given for New Testament, Roger Cotton, Hebrew Bible, Laurel Koepf-Taylor for Gender Studies, jointly, Brendon Benz and Jim Wilson for Pedagogy, and Victor Matthews the regional scholar program.

Second, I thank those who have chosen to present the fruits of their scholarship, those who gather for this meeting. Included in my thanks is an expression of gratitude to Dr. Barbara Rossing, our plenary speaker.

Third, I offer a special thanks to the publishers who contributed in various ways to our book display: **Eerdmans, Abingdon, Baker, IVP, SBL, Hendrickson and Zondervan**. If I've left any out, it is because the arrangements were made after this printing.

Thanks to the staff of the Stoney Creek Hotel and Conference Center, Columbia Missouri for continuing to assist us in this our second year at Stoney Creek. Also, thanks to William Jewell College's Central Services for their assistance with name badges, programs and AV equipment.

Finally, SBL continues to work well with the regional coordinators, most especially in assisting us to keep regional webpages updated and keeping track of our budget. This year they helped us again by overseeing on-line registration. My thanks to Paige Schmidt, who has in the middle of the year taken the reigns from Charlie Haws, and Samantha Spitzner for their patient assistance in helping us navigate new challenges for regional meetings.

This is my last year as Regional Coordinator, a surprise retirement from William Jewell making it necessary that I take some other career directions. We will talk about the future of the Region at our business session on Monday, March 12th.

Respectfully,

Milton Horne, Regional Coordinator

Special Sessions

Publishers Display and Bookstore

Sunday, 1:00 pm – 5:00 PM

Monday, 9:00 am – 1:00 PM

Please visit the Publishers Display and Bookstore in the Columbia Room. You will find resources for your classes, scholarly research, and your own personal study. Many titles will be significantly discounted.

Special Session I: Sunday Evening Dinner and Plenary, 6:00 – 8:00 PM

Dinner is included in the registration fee for all full-members. Persons who would like to purchase banquet tickets may do so at the Registration Table for **\$37.00**, while supplies last.

Plenary Speaker: Dr. Barbara Rossing

Professor of New Testament
Lutheran School of Theology at Chicago

"Ecology and the Book of Revelation"

Special Plenary Session II: Breakfast Planning Meeting

Monday, 7:15 – 8:00 AM (Galley)

The various sections will meet together, select chairpersons, plan for next year's sessions, and discuss other matters, including the plenary speaker for 2016. Breakfast will be in the Galley and part of the complementary hotel breakfast

Special Session III: A Conversation with Barbara Rossing

Monday, 8:15-9:00 AM (Timberlands) This is an opportunity for all sessions to meet with Barbara Rossing, our plenary speaker, to discuss her address and other matters of appropriate interest to the membership.

Special Plenary Session IV: Monday Plenary Business Session Lunch and Business Meeting, (Salon C)

Monday, 12:00 pm – 1:00 PM

A deli style buffet will be served for all those who purchase the lunch (**\$23.00 in advance; \$25.00 at the meeting**). The business session will bring us up to date on concerns for our regional ARM of the SBL, including our annual financial report and the future of the Region. Several issues are before us: 1. Milton Horne's resignation as Regional Coordinator; 2. Future venue for the meeting; 3. Future format of the meeting.

Chronological Schedule

Sunday Morning

Publishers Display and Bookstore 1:00 PM – 5:00 PM (Columbia)

Registration (pre-registrants pick up name tags) 10:30 AM – 5:00 PM

Sunday Afternoon

Sunday 1:00 - 2:00, Pedagogy (Timberlands)

Conveners: Brendon Benz, William Jewell College
Jim Wilson, Asbury Seminary

General discussion, and consideration of future of the section.

Sunday 3:00 - 5:00, Hebrew Bible I (Timberlands)

Convener: Roger Cotton, Assemblies of God Theological Seminary

- 3:00 **Victor H. Matthews**, Missouri State University
“Full Truth and Half Truth and No Truth: Political Jockeying in King David’s Court.”
- 3:40 **Brendon C. Benz**, William Jewell College
“The Reforms of Jeroboam I: Religious Heresy or Political Orthodoxy?”
- 4:20 **Richard Liantonio**, PhD candidate, University of Manchester
“Happiness is Light: Examining a Significant Conceptual Metaphor in the Hebrew Psalter”

Sunday 1:30 – 5:00, New Testament I: Jesus/Gospels (Columbia)

Convener: James Ware, University of Evansville

- 1:30 **Walt Harper**, Faulkner University
“Lower Galilee: The Land That Jesus Walked”

- 2:00 **Becky Walker**, Saint Louis University
“Almsgiving Is Better than Virginité: John Chrysostom’s Interpretation of Matthew 25:1–13”
- 2:30 **Hans M. Moscicke**, Marquette University
“Echoes of Yom Kippur in Matthew’s Barabbas Account (Matt 27:15–26): Jesus as Immolated Goat, the Crowd as Sin-bearing Scapegoat”
- 3:00 **BREAK**
- 3:30 **Kirby Applegate**, Durham University, UK
“Second Temple Development in the Divine Fatherhood Metaphor”
- 4:00 **Charles Hedrick**, Missouri State University
“The Earliest ‘Christmas Story’”
- 4:30 **Dean Furlong**, Vrije Universiteit Amsterdam
“The Confusion of John and Mark in Christian Sources”

Sunday Evening

Special Session I: Sunday Evening Dinner and Plenary 6:00 – 8:00

Dr. Barbara Rossing, Professor of New Testament, Lutheran School of Theology at Chicago

"Ecology and the Book of Revelation"

Student Paper Award: Congratulations to:

Chingboi Guite, Lutheran School of Theology at Chicago,
“The *Golah* Community Welcomes ‘Other’ People to their First Passover (Ezra 6:19–21)”

Scott Bayer, Claremont School of Theology, “Women, Virginité, and the Covenant Code”

Monday Morning

Special Session II: Breakfast Planning Meeting

Monday, 7:15 – 8:15 AM (Galley)

Special Session III: A Conversation with Barbara Rossing

Monday, 8:15 – 9:00 AM (Timberlands)

This is an opportunity for all participants to meet with Barbara Rossing, our plenary speaker, to discuss her plenary address and other matters of appropriate interest to the membership.

Monday morning 9:00-11:00, Hebrew Bible II (Timberlands)

- 9:00 **Scott Bayer**, PhD student, Claremont School of Theology
“Women, Virginity, and the Covenant Code: How Ancient Law Protects Women Within a Hierarchical Social Structure”
- 9:40 **Tad Blacketer**, PhD candidate, Asbury Theological Seminary
“From Rehoboam to Ahaz: Deuteronomistic Framing within a Hezekian Edition of Kings”
- 10:20 **Chingboi Guite**, PhD student, Lutheran School of Theology at Chicago
“The *Golah* Community Welcomes “Other” People to their first Passover (Ezra 6:19–21)”

Monday morning 11:00 - Noon, Gender Issues (Timberlands)

General conversation on Gender Issues

Convener, Laurel Koepf Taylor, Eden Theological Seminary

Monday 9:30 – 12:00, New Testament II: Acts/Paul

Convener: Mark Given, Missouri State University

- 9:30 **Anna Rebecca Williams**, Saint Louis University
“Simon Magus and Early Christian Attitudes toward Magic”

- 10:00 **James Ware**, University of Evansville
“The Eternal Reign of the Son: 1 Cor 15:24-28”
- 10:30 **Ben Nickodemus**, Concordia Seminary, St. Louis
“Letters of Recommendation in light of Roman Epigraphy: A non-Mosaic reading of 2 Cor 3:1-3”
- 11:00 **Robert L. Mowery**, Illinois Wesleyan University
“Comfort in 2 Corinthians 1:3-7: Clues Concerning Unidentified Pauline Scriptural Quotations?”
- 11:30 **Tim McNutt**, Concordia Seminary
“Is Paul’s Torah Cup Half-Full or Half-Empty?”

Monday Afternoon

Special Session IV: Monday Plenary Business Session

Lunch and Business Meeting (Salon C)

Monday, 12:00 pm – 1:00 pm

Monday 1:00 – 3:00, New Testament III (Timberlands)

Convener: Mark D. Given, Missouri State University

- 1:00 **Matthew C. Easter**, Missouri Baptist University
“‘Root of Bitterness Defiling Many’: An Intertextual Reading of Sexually Immoral Esau in Hebrews 12:15-17”
- 1:30 **Kyle Taft**, Midwestern Baptist Theological Seminary
“The Use of Hymnic Material in the General Epistles”
- 2:00 **David Armstrong**, Missouri State University
“They Will See His Face: Angelification, Christification, and Deification in John’s Apocalypse”
- 2:30 **Sidney Blankenship**, Associate Fellow, Oxford Centre for Animal Ethics
“An Ethical Perspective on Diet and Animals in the NT”

Minutes

Business Meeting of Central States Regional SBL/ASOR March 13, 2017

1. Horne called meeting to order. There were seventeen (17) members present. Horne noted Benz's regrets for absence, but had to return Dan Fleming to the airport in Kansas City early to avoid winter storm in upper Northeast.
2. Adopted the minutes with the budget report from the previous year (see program), including balance on hand as of Jan. 2017.
3. The agenda was as follows:
 - a. Evaluation of Stoney Creek hotel. The cost was comparable to last year's stay at the Marriott in St. Louis. Everyone voiced approval. Would like to return, pending affordability. All liked the location, especially those from Springfield and Kansas City. Wondered why there were not more from the central part of the state.
 - b. Noted that next year NT is sponsoring our plenary speaker. First choice for next year is Barbara Rossing from Lutheran School of Theology in Chicago; second choice is Margaret Mitchell from University of Chicago.
 - c. Low attendance this year. All were concerned and made suggestions for next year: a. let out another RFP for competing hotels in the area: competition never hurts and probably will help; b. recruit personally for more member-scholars (as opposed to student scholars alone) to attend and present papers. Shared Dan Fleming's suggestions that sections hand pick presenters for their sections.; c. choose popular appeal in plenary speakers, like Barbara Rossing (though not everyone in the room had ever heard of her). Still, NT is likely to draw a larger crowd.
4. Adjourn.

Society of Biblical Literature

Statement of Financial Position - *Regions Balance Sheet 740 - Central States Region As of 12/31/2017

	<u>Current Year</u>
Assets ^[1] _{SEP} Cash and cash equivalents	4,557.81
Total Cash and cash equivalents	4,557.81
Total Assets	4,557.81
Net assets ^[1] _{SEP}	
Unrestricted Net Assets ^[1] _{SEP}	
4,607.51	
Increase (decrease) in Net Assets	(49.70)
Total Net assets	^[1] _{SEP} 4,557.81
Total Liabilities and Net Assets	4, 557.81

Business meeting agenda:

1. Call to order and reading of the minutes (2017 meeting)
2. Old business
3. New business
 - a. Election of new Regional Coordinator (Horne's resignation)
 - b. Future of the Central States Region
 - c. Next year's meeting location
4. Adjourn

